

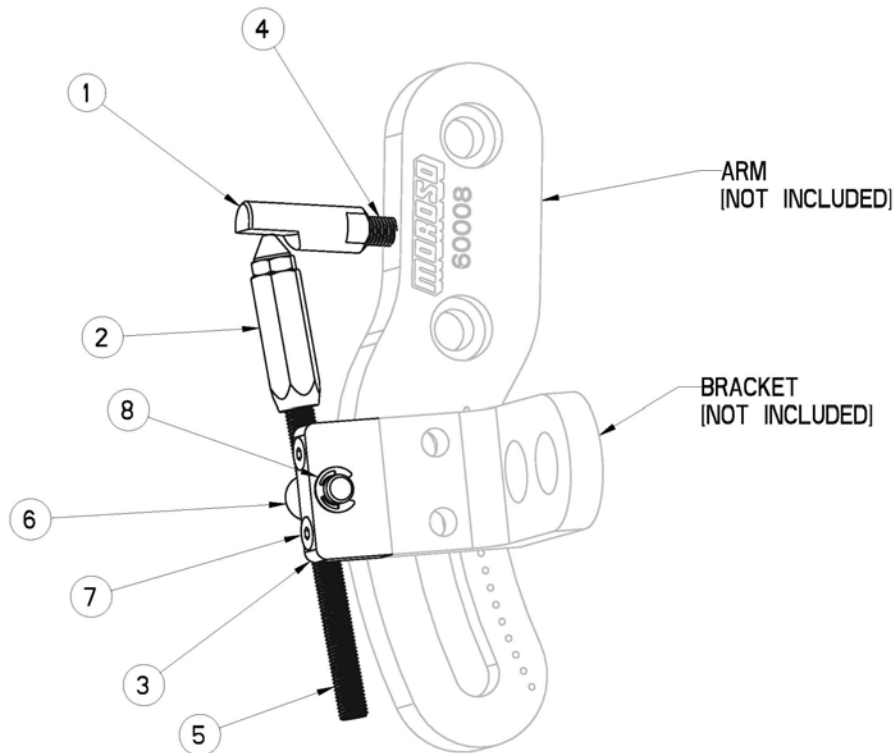

INSTALLATION INSTRUCTIONS

P/N: 60025, ULTRA-SERIES CRANK TRIGGER ADJUSTER

This crank trigger adjuster kit has been specifically designed to work with the MOROSO Ultra-Series Crank Triggers.



PARTS LIST

ITEM	DESC	QTY
1	Ball Joint	1
2	Hex	1
3	Extension Block	1
4	Stud	1

ITEM	DESC	QTY
5	Threaded Rod	1
6	Swivel	1
7	10-24 Flat Head	2
8	E-Clip	1

INSTALLATION

1. Loosen the crank trigger **Arm**
2. Loctite® 262 and install **Stud** into the Crank Trigger **Arm** hand tight until it stops.
3. Screw the **Ball Joint** onto the **Stud** until it is about a ½"-¼" away from the **Arm** and it is positioned as shown in the parts list. **DO NOT** bottom it on the **Stud**. **DO NOT** use Loctite®
4. Loctite® 262 and screw the **Hex** onto the male side of the **Ball Joint** until it is tight as shown in the parts list.
5. Loctite® 262 and screw the **Threaded Rod** into the **Hex** until it is tight.
6. Spin the **Swivel** onto the **Threaded Rod**
7. Fasten the **Extension Block** to the crank trigger **Bracket** so that the chamfered side of the large hole faces the motor. Use Loctite® 242 on the **Flat Heads** and tighten.
8. Adjust the position of the **Swivel** and insert it through the backside of the **Extension Block**.
9. Install the **E-Clip**.
10. Let the thread locker cure overnight.

SETTING THE ENGINE'S TIMING AND USING THE ADJUSTER

1. If it is not possible to let the thread locker cure overnight, use care to not loosen the Crank Trigger Adjuster components.
2. Loosen the crank trigger **Bracket**. The Adjuster must be able to be turned by hand. If a wrench is necessary to advance or retard the timing, than the **Bracket** is too tight.
3. Follow the crank trigger installation instructions to set the timing.

**For Technical Assistance, Call Moroso's Tech Line at
(203) 458-0542, 458-0546 8:30am – 5:00pm Eastern Time**

MOROSO PERFORMANCE PRODUCTS, INC
80 CARTER DR • GUILFORD, CT 06437-2116
Phone: (203) 453-6571 • Fax: (203) 453-6906

Visit Us At www.moroso.com