



STEERING COLUMN KIT

P/N: C5073 – STEEL

P/N: C5074 – CHROME MOLY

INSTALLATION INSTRUCTIONS

This kit is designed for use in race cars with fabricated tube style chassis. Its universal design allows it to be adapted to Drag Race, Pro-Street and Circle Track vehicles. We have included a stop collar that will mount onto the shaft to prevent the column tube from entering the driver's compartment in case of impact. This kit requires that all components be GTAW (TIG) process welded. We recommend that you use this kit with Competition Engineering P/N: C5076 Steering Column Mount Kit.

We purposely do not include the steering box U-joint in this kit due to the variety of boxes being used in racing. Steering Box U-joints are available through Moroso and Competition Engineering.

PARTS LIST

- | | |
|-------------------------------|----------------------------------|
| 1) Stop Collar | 2) 3 FT 3/4" o.d. Steering Shaft |
| 2) Nylon Shaft Bushing | 1) Aluminum Steering Column |
| 4) 1/8" Rivets | 1) 3/4" i.d. U-Joint |
| 1) Quick Release Steering Hub | 1) Steering Hub Adapter |
| 2) Grease Fittings | |

INSTALLATION

1. Insert the **Steering Hub Adapter** into the **Quick Release Steering Hub** and bolt this assembly to your steering wheel.
2. With the driver seated in the vehicle, in race position, measure for proper placement of the steering shaft. This is done as follows:
 - a. With the driver holding the steering wheel/quick release hub assembly in the proper position, measure vertically from the floor of the vehicle to the center of the **Steering Hub Adapter**.
 - b. Next, measure horizontally from the firewall to the center of the **Steering Hub Adapter**. This will give the coordinates for the steering wheel position. (See Diagram 1)
3. Press the supplied **U-Joint** over one end of the **Steering Shaft**. This end goes through the firewall.
4. Slide the **Stop Collar** over the **Steering Shaft** until it touches the **U-Joint**. Do not tighten at this time.
5. Support the length of **Steering Shaft** so that the steering wheel end is held at the dimension determined previously and is centered with the driver's seat.
6. Raise or lower the opposite end of the shaft to achieve the desired steering wheel angle. Support the end of the shaft in this position.
7. Mark the position where the lower end of the shaft meets the firewall. Cut a hole in the firewall to allow the shaft to slide through. It is better to make a large hole to allow for adjustment and make a patch panel to fit around the shaft, than to make a small hole and risk tearing the firewall sheetmetal.

*For Technical Assistance, call Competition Engineering's Tech Line at
(203) 458-0542, 203-458-0546 8:30am-5:00pm Eastern Time*

COMPETITION ENGINEERING

80 Carter Drive • Guilford, CT 06437

Phone: (203) 453-5200 • Fax: (203) 453-6906

Visit Us At www.competitionengineering.com

8. Slide the u-joint end of the shaft through the firewall hole. Support the shaft in place with wire from the roll cage and dash bar at the correct dimension.
9. Install your steering box u-joint onto the steering box shaft. Measure the distance between the steering box u-joint and the steering shaft u-joint. Remember to account for the depth of the u-joint socket.
10. Cut the second piece of **Steering Shaft** to the distance just measured. Trial fit the piece in place.
11. Check for adequate header and chassis clearance. Move the shaft assembly as necessary to achieve clearance. Remember to keep the upper shaft centered to the driver's seat.
12. With the steering shaft angle set, cut the **Aluminum Column Tube** to length so that it mounts 1" from the firewall and 2" from the steering wheel end of the shaft.
13. Install the **Nylon Bushings** into the ends of the **Aluminum Column Tube**. Fasten the bushings in place with the supplied **Rivets**. We have also supplied two **Grease Fittings** with the kit to enable you to lube the column for friction free steering. We recommend that you drill through the column tube and nylon-bushing 1/2" from the end of each tube using a No.7 drill bit. Next, tap the hole with a 1/4"-28 UNF tap. Install the fittings.
14. Slide the column assembly over the upper steering shaft. At this time, you may trim the steering shaft if it is too long.
15. Remove the steering assembly from the vehicle and install the hex shaped **Steering Hub Adapter**.
16. Weld the **Steering Shafts** to the u-joints and the **Steering Hub Adapter** at this time. **DO NOT REMOVE THE COLUMN TUBE FROM THE SHAFT DURING WELDING!**
17. After the welds have cooled, re-install the shaft assembly in the vehicle. Mount the column in place using the Competition Engineering P/N: C5076 Steering Column Mount Kit. This kit includes the mounting struts, column tube clamps, and all hardware.
18. Slide the **Stop Collar** up so that it is 1/2" from the bottom nylon steering column bushing. Tighten the set bolt. This collar will help to prevent the steering column shaft from sliding into the driver's compartment in case of an impact.
19. Install the steering wheel and adjust the tie rods to center the wheel.

C5073/C5074INST
(082112)
REV C

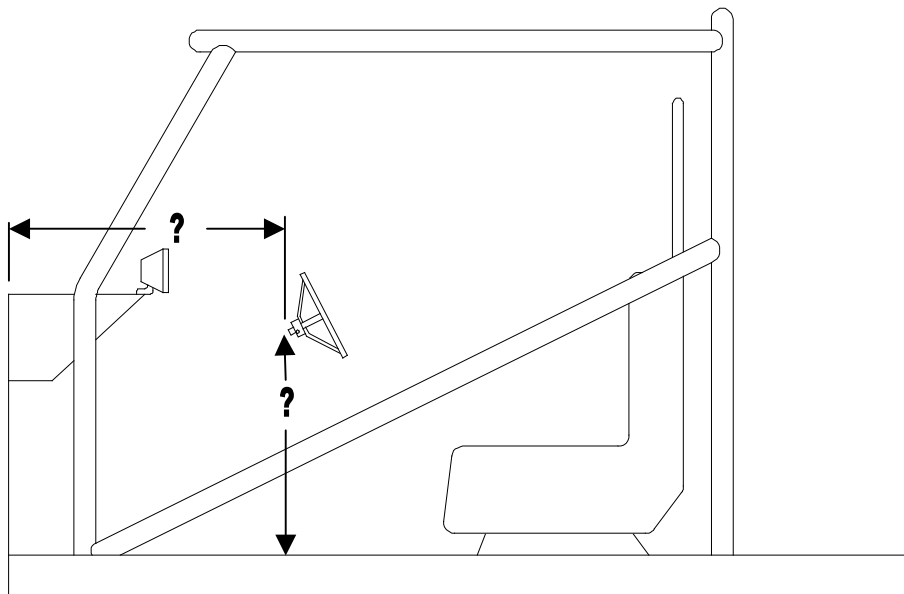

Diagram 1

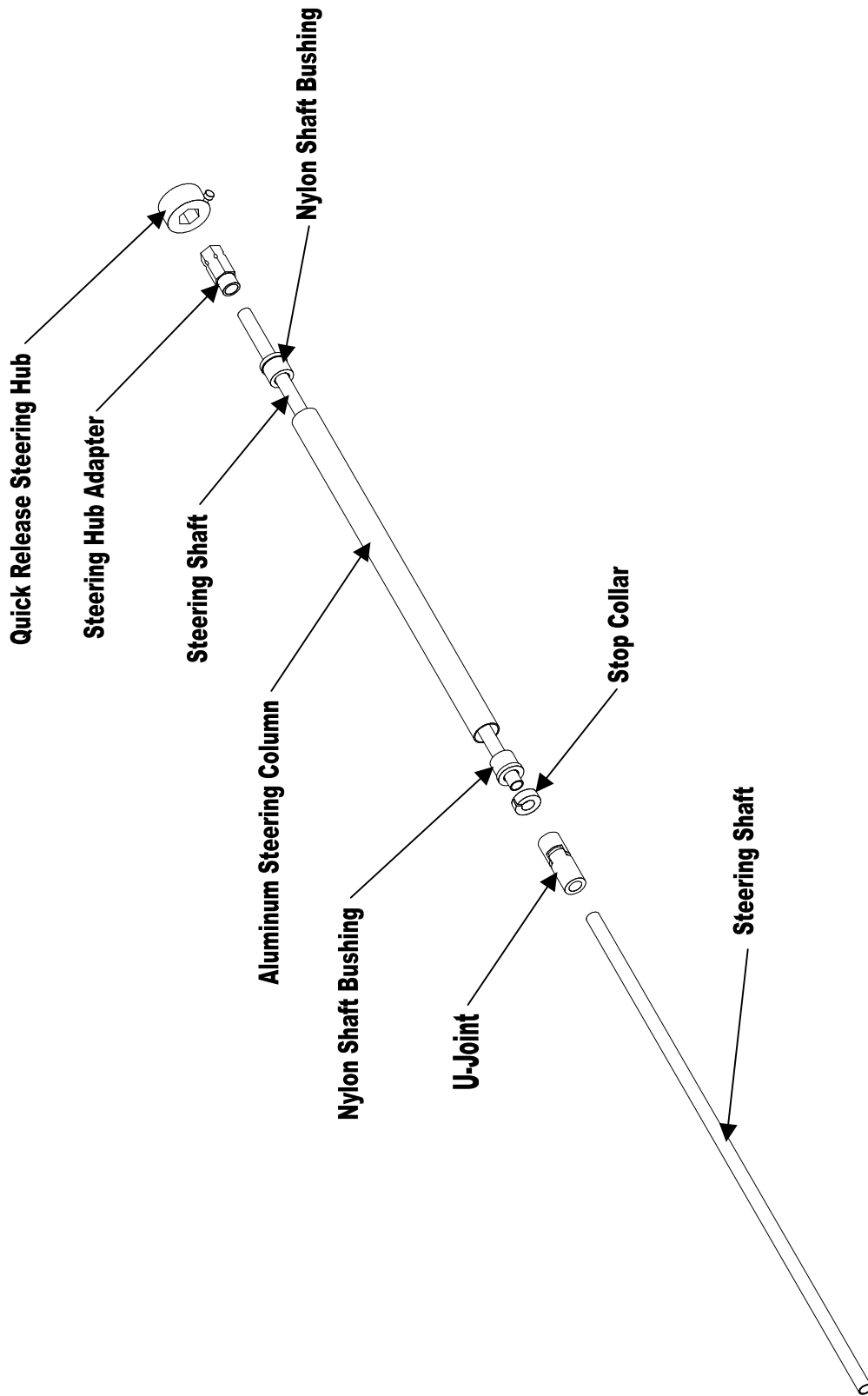

Diagram 2



INSTALLATION INSTRUCTIONS

SFI CERTIFIED QUICK RELEASE STEERING WHEELHUB AND ADAPTER P/N 80160

The parts in this kit are designed to work together and are certified by SFI to meet sanctioning body regulations, and therefore should remain together as a set.

The Quick Release Steering Wheel Hub Adapter fits a .750" o.d. steering column and the Steering Wheel Hub will accept a steering wheel with a 1.75" bolt circle mounting flange.

1. Slide the adapter over your steering column and determine the desired length of the column.
2. Cut the column to length so that it extends to within 1/8" of the end of the adapter. (see diagram on back)
3. Position the adapter properly to index the steering wheel to the driver's preference.

NOTE: An easy way of doing this is to bolt the steering wheel to the quick release hub and using this to set index and overall length.

4. When the adapter is set to your preference, weld it to the column by GTAW (TIG) process in the areas shown in the diagram on back. Be careful not to allow any bleed through onto the hex area as the steering hub has a close tolerance fit and will not slide properly over the adapter if there is buildup in this area.
5. Bolt the steering wheel to the hub, making sure the mounting bolts do not bottom out in hub threaded holes.
6. Once the hub is securely attached to the steering wheel, install the steering wheel to the adapter by depressing the hub release pin in and sliding the steering wheel and hub assembly onto the hex adapter on the steering shaft until it locks into place.
7. Pull back on the steering wheel to make sure the pin is locked in its groove on the adapter.
8. To release the steering wheel, push the release pin in and pull back on the steering wheel.
9. Proper maintenance of the unit should be followed to keep it working trouble free. This includes keeping the adapter free of nicks or burrs, cleaning and greasing the hub and adapter frequently.

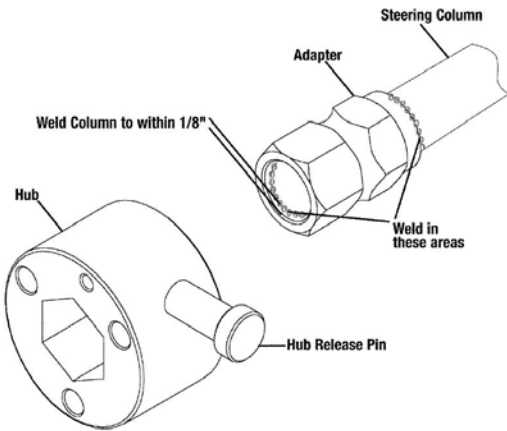

For Technical Assistance, Call Moroso's Tech Line at
(203) 458-0542, 458-0546 8:30am – 5:00pm Eastern Time
MOROSO PERFORMANCE PRODUCTS, INC
80 CARTER DR • GUILFORD, CT 06437
Phone: (203) 453-6571 • Fax: (203) 453-6906

VisitUsAt www.moroso.com